



PVG Automotive PVT LTD. Pune

IATF 16949-2016 Certified Company

Company Profile

ABOUT US

PVG Technology – Design & Development

PVG Automotive Pvt Ltd – Manufacturing of EV components

IATF 16949 : 2016 Certified Companies

Established in 2012

Headquartered in Pune, Maharashtra, India

Expertise in area of automotive, Aircraft components, Industrial equipment's and machine tools

Industrial training in Automotive product design i.e. Interior Trim Design, Exterior Trim Design, BIW Design, Vehicle Integration, Wiring Harness, Tool Design

Company Assets

Experienced team with more than 30 years of experience in automobile Plastic, Sheet Metal & Wiring Harness design.

INDEX

☐ **Electric Vehicle Components**

- ELECTRONIC THROTTLE (SINGLE / TWO SWITCH)
- DC - DC CONVERTOR
- INDICATOR FLASHER RELAY
- JUNCTION BOXES / CONNECTION BOXES - 6 POLE
- POWER DISTRIBUTION BOX
- ELECTRIC VEHICLE WIRING HARNESS

☐ **Wiring Harness**

- Hybrid Electric Vehicle Wiring Harness

☐ **Other Component**

- ☐ 5 WAY ONE MEGA 4 MIDI- FUSE BOX
- ☐ OBD CABLE
- ☐ INJECTOR ADAPTOR CAPS, HATS
- ☐ DUAL TEMPERATURE SENSORS
- ☐ THERMO AMP UNITS
- ☐ BACK COVER
- ☐ POWER CORD (BATTERY CHARGING PLUG)

SINGLE / TWO SWITCH THROTTLE

Electronics Twist Throttle/ Accelerator Electric 2 & 3-wheeler

Key point:

- Suitable for battery operated bicycle, 2 and 3-Wheeler with 24, 36, 48, 60 and 72 V Battery system.
- Hall Effect magnetic sensor for long operational life with no friction.
- Without switches Throttle is also available.
- Easy adoptability - Pig tail length and connector can be as per requirement.
- Customisation - Customer's logo / name can be moulded on rubber grips
- Switches : I II III, L M H, F R , L H, H L, Push switches – P, R etc, as per requirement

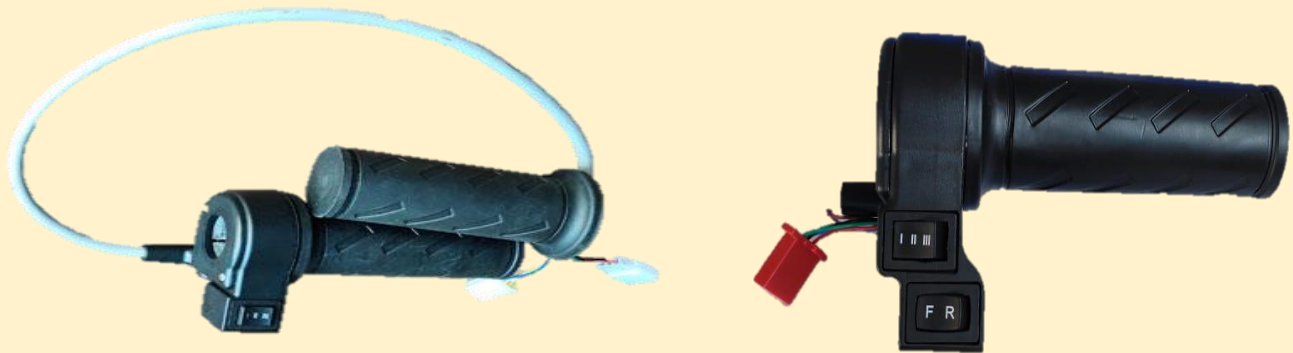

SPECIFICATIONS		
DESCRIPTION	UNIT	VALUE
Input Supply Voltage	Volt (V)	5
Output Voltage	Volt (V)	0.8 To 4.2
Maximum Operating Force	Newton (N)	22-25
Ambient Temperature	Degree Celcius (°C)	-10 TO 50
Handle Diameter	mm	22 TO 22.4
Grip Outer Diameter	mm	34.6
Throttle Rotation Angle	Degree	67 +/- 0.2

Key point:

- Protections – Under voltage (input side), over current, short circuit (output side)
- Ingress protection level IP 65
- Line and load regulation - 2%
- Easy installation – Uses M6 screw for mounting
- Good heat dissipation – Uses aluminum extruded housing
- Connectivity - Pig tail length and connector type can be customized.

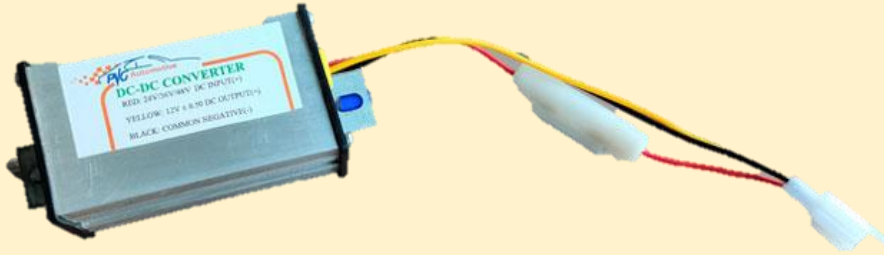

SPECIFICATIONS		
DESCRIPTION	UNIT	VALUE
Input Supply Voltage	Volt (V)	24/36/48/60/72
Output Voltage	Volt (V)	12 ± 0.5
Current	Ampere (A)	10
Temperature	Degree Celcius (°C)	-0 TO 70
Dimensions	mm	L= 88mm, W= 46mm, H= 28mm

Key Point:

- Long operational life – No moving parts inside, no wear and tear
- State of the art technology – Uses SMD chip Technology
- Protections – Short circuit protection, overload protection, reverse polarity
- Flasher frequency - In accordance with IS 4060
- Load - 10W Front lamp.+ 10W Rear lamp + 3.4 W Tell tale lamp in instrument cluster.
- Outage lamp detection.
- Also available for LED and Filament type indicators.
- With and without Buzzer options are available.



SPECIFICATIONS		
DESCRIPTION	UNIT	VALUE
Input Supply Voltage	Volt (V)	12/24
Output Voltage	Volt (V)	$12 \pm 0.5/24 \pm 0.5$
Max. Output Current	Ampere (A)	5
Temperature	Degree Celcius (°C)	-0 TO 70
Flasher frequency	Flash per Minute (F/M)	90 ± 10

JUNCTION BOXES / CONNECTION BOXES - 6 POLE

Key Point:

- 6 Pole
- Provision of rubber tie to hold cover with base
- Provision of captive screw
- Chamfer for easy fitment of nut & screw
- Provision of mounting holes for vehicle fitment

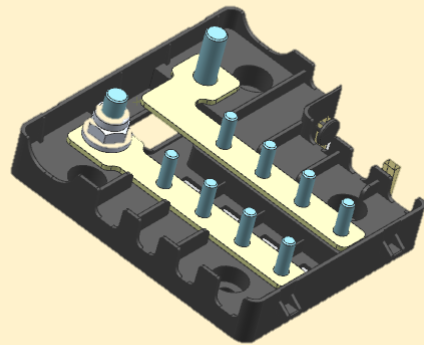

SPECIFICATIONS		
DESCRIPTION	UNIT	VALUE
Supply Voltage	Volt (V)	48/60/72
Flange Nuts for Connections	-	M5
Max. Output Current	Ampere (A)	5
Temperature	Degree Celcius (°C)	-0 TO 50

POWER DISTRIBUTION BOX

Key Point:

- High Voltage Power Distribution Unit suitable for Electric Bus, Electric LCV and Two wheeler vehicle.
- Expertise in house design and development.
- Ingress protection IP 67
- Length of wire will be dependent on location of different equipment, location of PDU and routing of cables on vehicle.
- Harness connection are Lug mounted / Connector based.

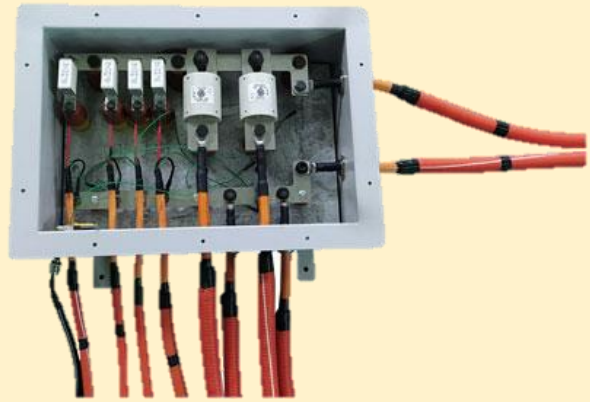

Key Features

- All components complying to automotive standards
- Calculations related to harness are considered in design stage
- Reliability & quality assurance on process of harness manufacturing
- Harness guarantee for vehicle life if mounted & used as per drawings
- Close coordination's with OEM for better fitment of physical harness
- OEM support with circuit level schematics (for service engineers), fitment drawings for harnesses (for assembly operators), troubleshooting documents etc on demand
- In time delivery

Advantages : Developed in India

Support to OEM for FAME II subsidy

Guide to service team of OEM for troubleshooting of vehicle

Wiring harness modifications can be done as per OEM suggestions

Design consultancy regarding integration of electrical components in electric vehicles

Hybrid Electric Vehicle Wiring Harness

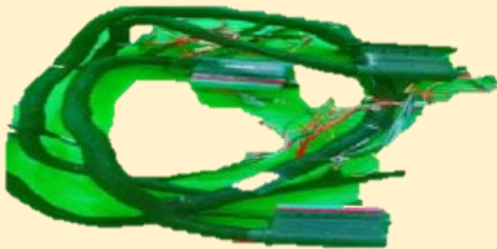

Electric Three Wheeler Wiring Harness



Wiring Harness

Electric Two Wheeler Wiring Harness

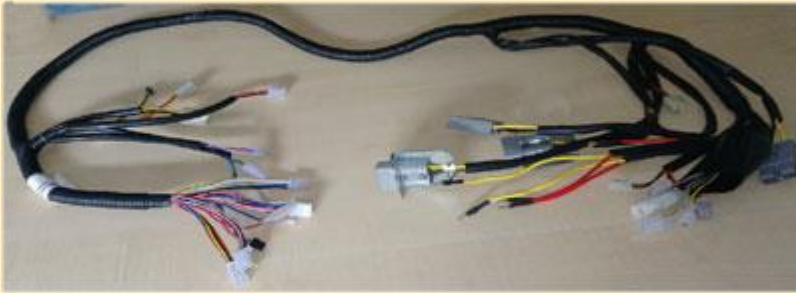

Regular Wiring Harness (IC Engine Vehicle)

Truck, Car, Genset Main Wiring Harness



ONE MEGA FOUR MIDI-FUSE BOX

Key Point:

- Fuse box is intended for use in commercial vehicle and Buses for power distribution purpose .
- It contains 1Mega fuse (for starter motor) and 4 midi fuses for power distribution in vehicle.
- Provision of rubber tie to hold cover with base
- Chamfer for easy fitment of nut & screw
- Provision of mounting holes for vehicle fitment



SPECIFICATIONS		
DESCRIPTION	UNIT	VALUE
Supply Voltage	Volt (V)	12/24
Flange Nuts for Connections	-	M6
Current	Ampere (A)	Continuous current 50% of Fuse rating

Key Point:

- Material: Plastic casing
- Universal OBD II 16 Pin Connector
- DB9 Connector for PC interface



Application - Provides vehicle self-diagnosis

INJECTOR ADAPTOR CAP



Application

Used in wiring harness of vehicles and provide protection to wires from sharp metal edges.

Duel Temperature Sensor



Application

Used in all IC engine vehicles. Measures coolant temperature & provides information to relevant systems.

THERMO AMP UNIT



Application

Compressor cycles ON and OFF to maintain the evaporator temperature within a specified range.

POWER CORD (BATTERY CHARGING PLUG)



Connector - IEC 320 C15 3-Port House Plug

Port N = Positive

Port L = Negative

250V, 10A

Application:- Power cord for charging two wheeler Electric vehicle.

BACK COVER



The adapter protection cap has been specially developed to protect exposed cables including strain relief for the cable harness, as well as protection against steel and splash.

Temperature:- -40°C to +135°C

Suitable for plug manufacturer: AMP-2

Suitable for corrugated tube profile Normal: NW 4.5

Contact us

Manufacturing Plant

PVG Automotive Pvt. Ltd.

PLOT NO-54/15 & 54/16,
D 2 BLOCK, MIDC,
CHINCHWAD, PUNE -411019,
MAHARASHTRA, INDIA

Design Office

PVG Technology

PLOT NO-54/15 & 54/16,
D 2 BLOCK, MIDC,
CHINCHWAD, PUNE -411019,
MAHARASHTRA, INDIA

Tel. No. : 020 - 27350603

Mob. No. : +91 - 90110 80603

+91 - 90110 60910

+91 - 90750 89610

Email- dharmap@pvgautomotive.com
dharmap@pvgtechnology.com

Website : www.pvgtechnology.com